

82

83

84

**City Memorial Hospital and Nurses' Home**  
**Latitude: 35.874304**  
**Longitude: -80.079165**

**City Memorial Hospital and Nurses' Home**  
**11 and 15 Pine Street**  
**608 Thomas Street**  
**Thomasville, Davidson County, North Carolina**  
**Location Map**

**THOMASVILLE**

**Fair Grove**

Fair Grove  
Methodist  
Church Cem

**SCALE 1:24 000**

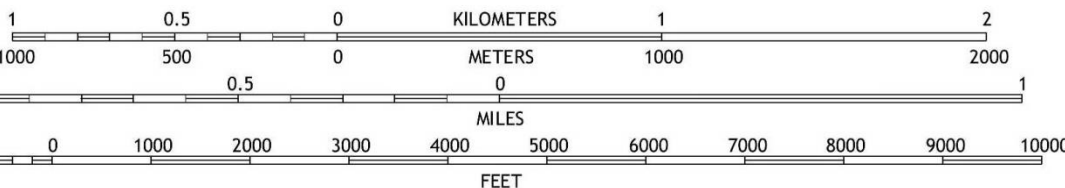



**City Memorial Hospital and  
Nurses' Home  
11 and 15 Pine Street  
608 Thomas Street  
Thomasville, Davidson County,  
North Carolina  
National Register Boundary Map,  
Site Plan, and Photograph Key**

City Memorial Hospital  
11 Pine Street, 1930 with  
1941 third-story additions  
and 1953 rear addition  
Contributing Building

National Register  
Boundary

Pine Street

Thomas  
Street

Nurses' Home  
15 Pine Street, 1934  
Contributing Building

8 →

1  
↓  
1930 1941  
1941  
1953

3 ↖

Rodella  
Street

9 ↙

2 ↑

Cannon Street

0.24-acre portion  
of tax parcel  
excluded from the  
National Register  
Boundary

12 ↘

13 →

0.05-acre municipal right-of-  
way not included in National  
Register Boundary

Ambulance Garage  
608 Thomas Street, 1950  
Contributing Building

2022 aerial from HPOWEB 2.0 @ <https://www.arcgis.com>  
Fearnbach History Services, Inc. / July 2025

100ft



**City Memorial Hospital  
11 Pine Street  
Thomasville, Davidson County, North Carolina  
First Floor Plan\* and Photograph Views**

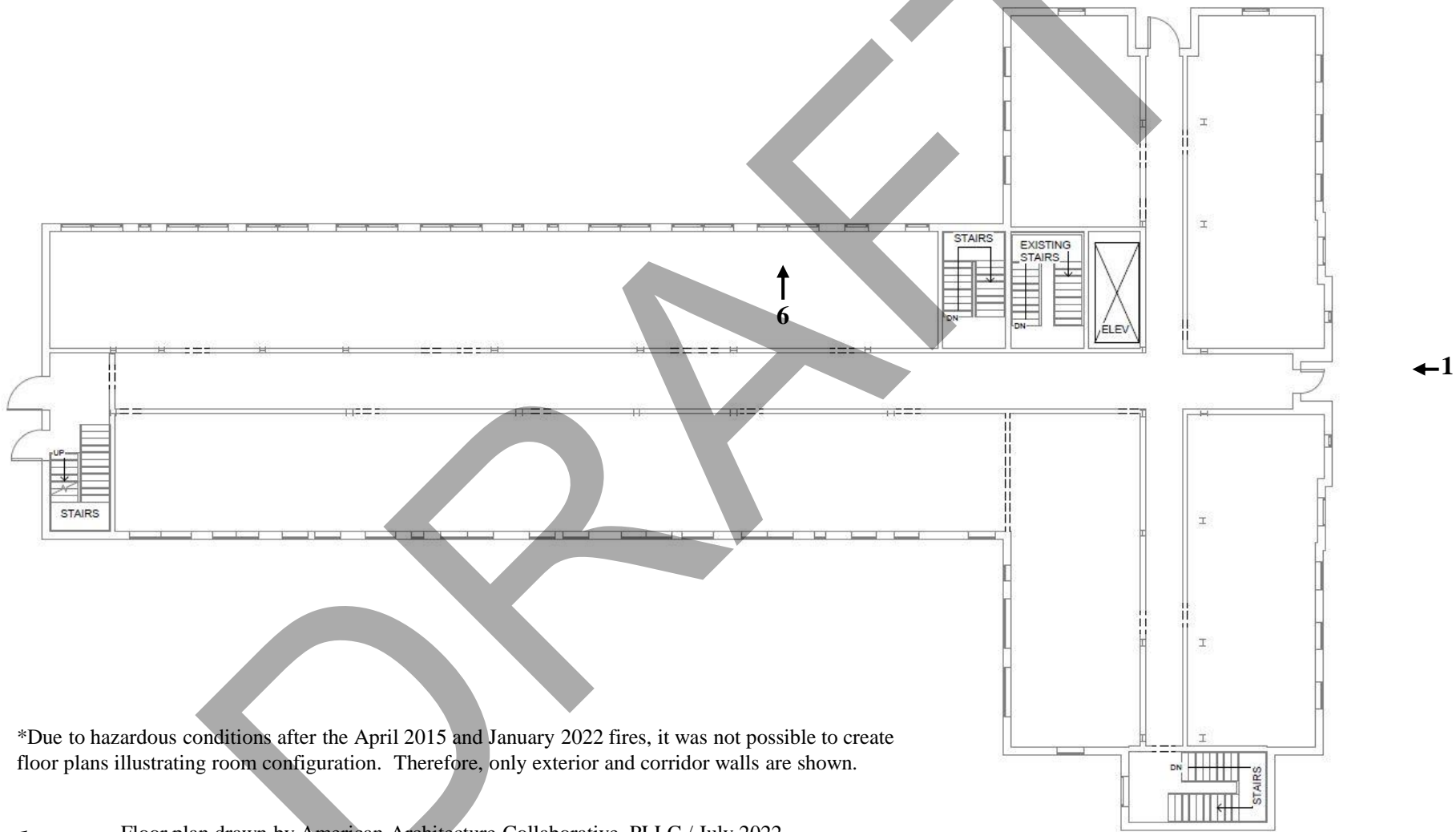

\*Due to hazardous conditions after the April 2015 and January 2022 fires, it was not possible to create floor plans illustrating room configuration. Therefore, only exterior and corridor walls are shown.

Floor plan drawn by American Architecture Collaborative, PLLC / July 2022  
Photograph views annotated by Fearnbach History Services, Inc. / July 2025

Scale at 24" by 36" size: 1/8" equals one foot

N →

**City Memorial Hospital  
11 Pine Street  
Thomasville, Davidson County, North Carolina  
Third Floor Plan\* and Photograph Views**

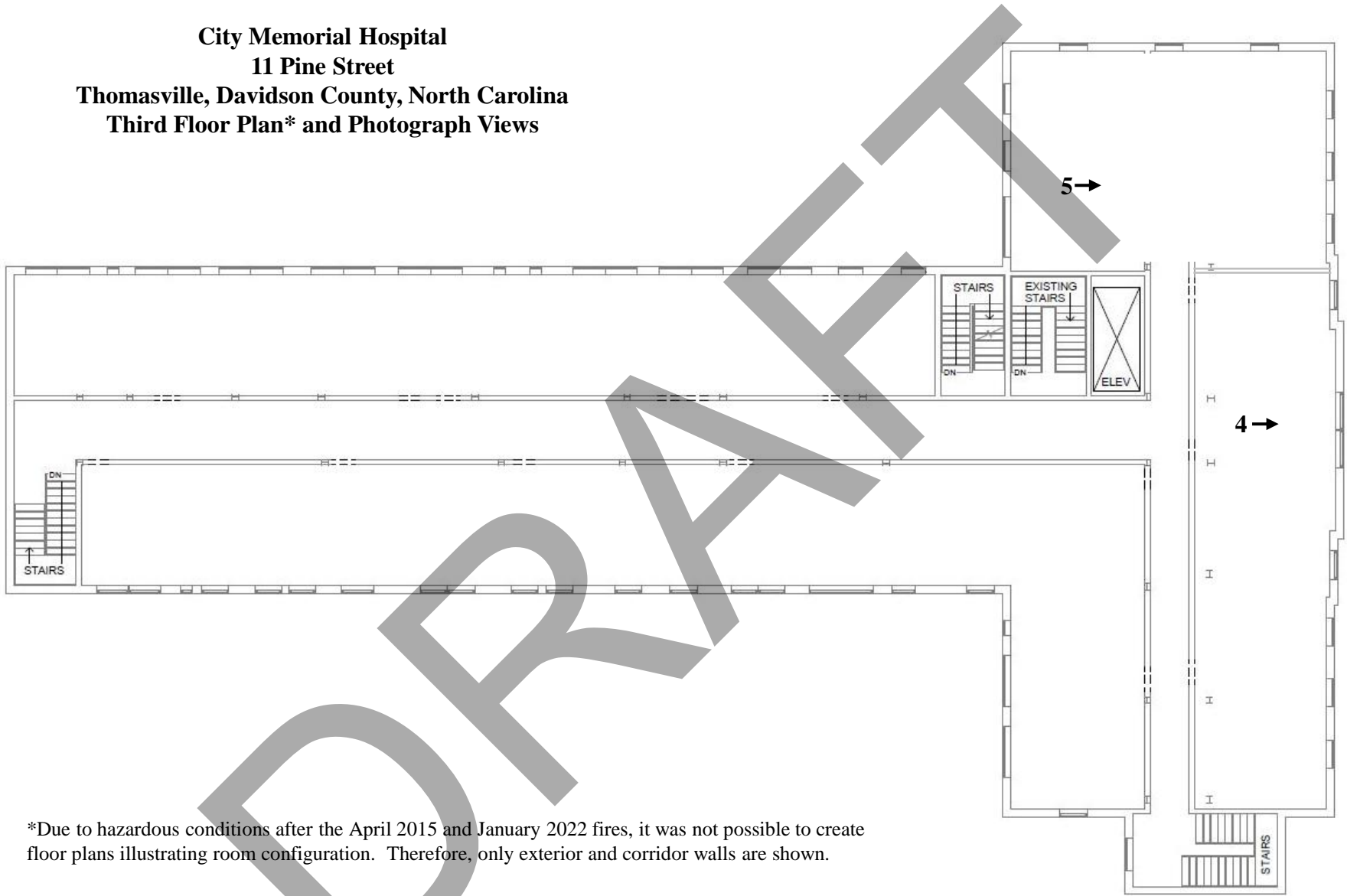

\*Due to hazardous conditions after the April 2015 and January 2022 fires, it was not possible to create floor plans illustrating room configuration. Therefore, only exterior and corridor walls are shown.

Floor plan drawn by American Architecture Collaborative, PLLC / July 2022  
Photograph views annotated by Fearnbach History Services, Inc. / July 2025

Scale at 24" by 36" size: 1/8" equals one foot

**City Memorial Hospital  
11 Pine Street  
Thomasville, Davidson County, North Carolina  
Basement Floor Plan\***

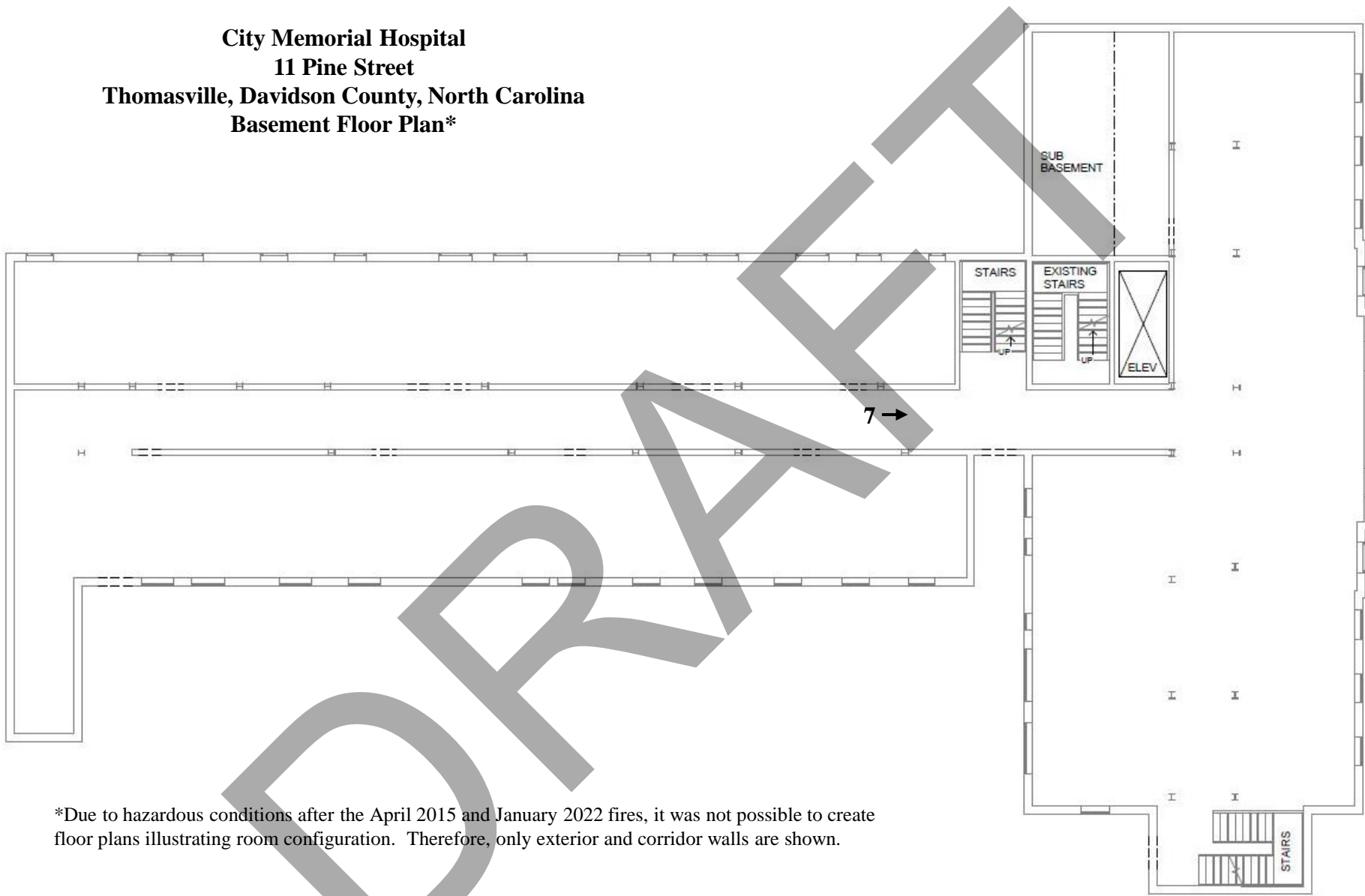

\*Due to hazardous conditions after the April 2015 and January 2022 fires, it was not possible to create floor plans illustrating room configuration. Therefore, only exterior and corridor walls are shown.

Floor plan drawn by American Architecture Collaborative, PLLC / July 2022  
Photograph views annotated by Fearnbach History Services, Inc. / July 2025  
Scale at 24" by 36" size: 1/8" equals one foot